

MQiGT





The SN Code of your scooter.
Please see P.6 for detailed information.

This owner's manual contains important safety, operational and maintenance information. Any person operating or riding as a passenger on your scooter should carefully read and fully understand the entire contents of this manual prior to riding the vehicle. For your safety, follow all safety warnings contained within the owner's manual and the labels applied to your scooter. If you have any questions, please ask your dealer for assistance.

 **WARNING California Proposition 65**

Lithium-ion Batteries and/or products that contain Lithium-ion Batteries can expose you to chemicals including cobalt, lithium, nickel oxide, and nickel, which are known to the State of California to cause cancer and birth defects or other reproductive harm.

For more information go to www.P65Warnings.ca.gov.

CONTENTS

General Notice	01
Precautions	02
Safety Notice	03
Downloading the APP	04
Installation Guide	05
Parts Info	06
Operation Guide	10
Battery Use and Maintenance	17
DOs and DON'Ts while Riding	23
Reporting Safety Defects	24
Federal Communications Commission (FCC)	25
Compliance Statement for USA	
Maintenance and Repair	26
Storage Method	28
Troubleshooting List	31
Technical Parameters	38
Maintenance Record	41

General Notice

- Please read this User Manual carefully for proper operation before riding the scooter.
- Please follow the traffic laws. Slow down on slippery roads in bad weather to allow greater braking distance for your safety.
- You should always use original OEM parts for all maintenance and repairs as they have been designed specifically for your vehicle.
- Your authorized dealer is the primary resource for information, parts and service. If you have additional questions about the product, please visit www.niu.com/us.

Precautions

Riding Conditions

This scooter is not designed for off-road use.

This User Manual should be deemed as a permanent document of the scooter. If this scooter is transferred to others, this User Manual should also be handed over to the new owner.

Reproduction or reprint of any part of this User Manual is strictly prohibited.

 **WARNING:** Do not exceed speed limit and apply brakes cautiously. Always use side stand or center stand when parking.

 **WARNING:** Failure to follow the instructions herein may lead to serious injuries or death.

Safety Notice

- Always wear a quality DOT approved helmet as well as suitable eye protection.
- Choose quality gloves, boots, pants, jackets and other riding apparel specifically designed with protective features. Loose clothing can be unsafe when riding your scooter.
- Wear bright, reflective apparel to make yourself visible to fellow drivers. Position yourself on the road where other drivers can easily see you.
- Use your turn signals, hand signs, horn and other methods to help others locate you and understand your driving actions.
- Road conditions can vary greatly with weather, foreign material, elevation etc. Your riding stability and braking power are limited by the grip of the tires on the road surface.
- When encountering slippery road surfaces, braking distance will increase significantly and riding stability will be reduced. Reduce vehicle speed and perform all actions in a gradual and deliberate manner to prevent accidents. Use extreme extreme caution on painted surfaces or metal objects such as manhole covers or train rails when they are wet.
- Please follow the Operation Guide (P.12) to fully understand how to properly operate the scooter.

Downloading the APP

Functions such as checking battery level, locating, and management can be implemented on the electric scooter through the app.

- Step 1** Scan the QR code below to download the APP titled Niu E-Scooter.
- Step 2** Run Setup after downloading and register.
- Step 3** Please scan the QR code on the inside of cover page for app registration.



NOTE:

The mobile phone system is required to be at least Android 4.0 or iOS 8. Make sure that the mobile phone has been connected to the Internet when running the app (Wi-Fi / 2G / 3G / 4G).

Installation Guide

- Step 1** Open the Accessories Box to take the tools.
- Step 2** Install the rearview mirrors into the mounting holes on dashboard and turn it clockwise. The bolt shall be screwed in for more than 15 mm.
- Step 3** Adjust the rearview mirror to an appropriate position and then tighten nuts on the rearview mirror with a spanner. Properly set the dust cover.

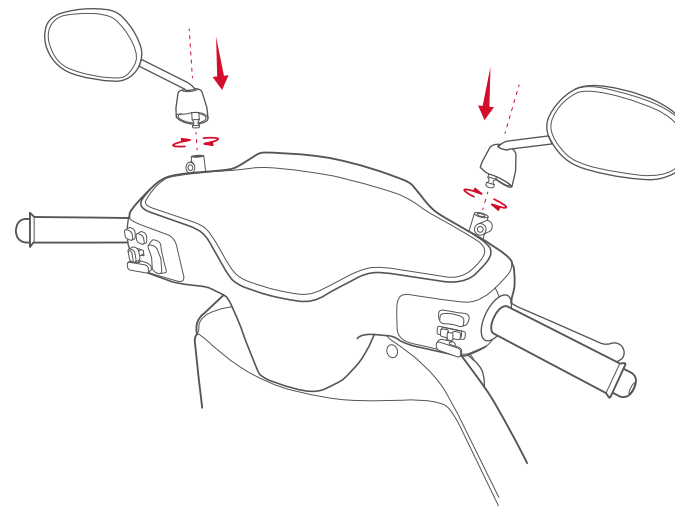

Parts Info

Part 567 Certification Labels

MADE IN CHINA

Manufactured By: JIANGSU NIU ELECTRIC TECHNOLOGY CO., LTD.			
Type of Vehicle: Motorcycle		Date:	
GVWR: 269 Kg(593 lbs)		VIN:	
GAWR	Dimension		Cold Inflation
	Tire	Rim	Pressure
Front: 92 Kg(192 lbs)	90/90-14	2.15*14	200 kPa(29PSI)
Rear: 177 Kg(401 lbs)	110/80-14	2.50*14	225 kPa(33PSI)
THIS VEHICLE CONFORMS TO ALL FEDERAL MOTOR VEHICLE SAFETY STANDARDS IN EFFECT ON THE DATE MANUFACTURE SHOWN ABOVE.			

VEHICLE EMISSIONS CONTROL INFORMATION LABEL
 GENUINE SCOOTERS, LLC
 ENGINE FAMILY: MGSCCLIONNET
 EXHAUST EMISSION CONTROL SYSTEM: BATTERY-ONLY ELECTRIC VEHICLE
 THIS VEHICLE CONFORMS TO U.S. EPA AIR EMISSIONS REGULATIONS APPLICABLE TO 2021 MODEL YEAR NEW HIGHWAY MOTORCYCLES.

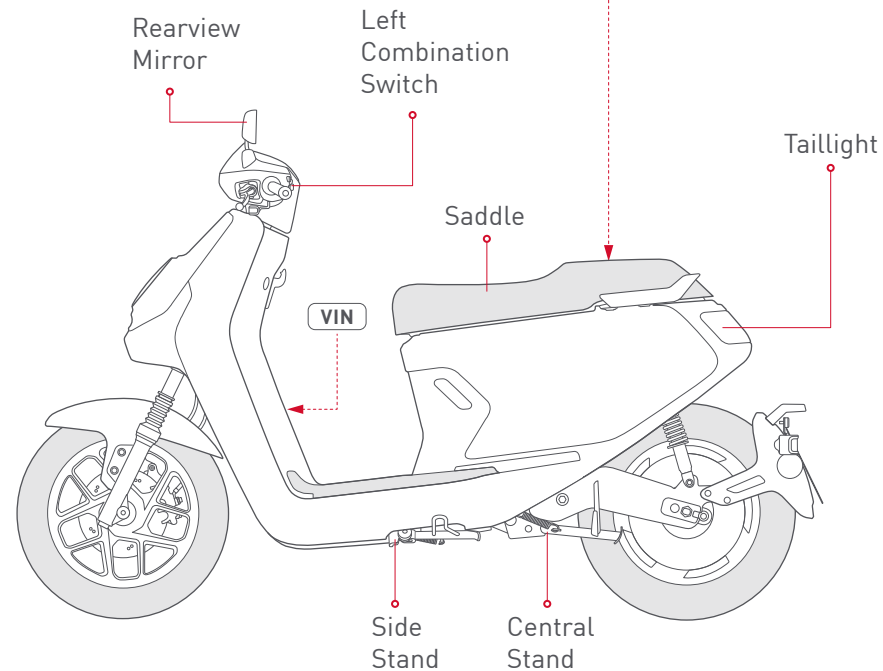
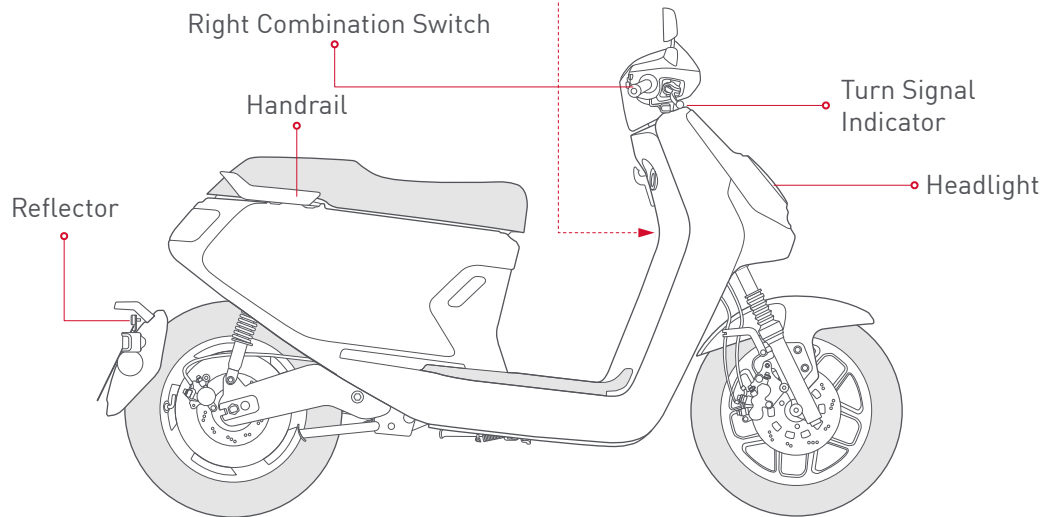

Dashboards and Combination Switches

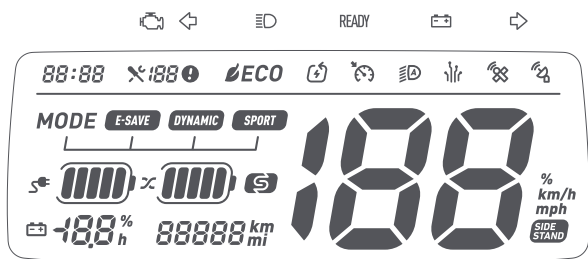

 OBD system



Error Code^[1]
Displayed when the scooter system reports an error

 Left Turn Signal Indicator



Eco Mode
Close to the optimal energy output power ratio

 Right Turn Signal Indicator



Energy Recovery
Lights up when in Energy Recovery mode

 High Beam Light



Lights up when in Cruising Mode

READY  Parking Indicator



Lights up when automatic headlight is enabled

 Low power



Cloud Service Connection
Displayed when smart data is connected

88:88  24 Hour Clock



GPS Signal^[2]

 Health Score
Displayed when the scooter is in poor condition



Cellular Network Signal^[2]



Lights up when in "on-board charging mode"



Real-time Battery Level
Displays the remaining charging time when charging



Speed
[When charging] Displays the real-time battery level



Total Mileage



Side Stand Indicator



Real-time Battery Level



When between 1%~20%, the leftmost bar will light up;
When between 21%~40%, the second bar will also light up;
When between 81%~100%, all bars will light up.



Riding Mode

Eco Mode Dynamic Mode Sport Mode

[1] The parking indicator will flash when an error code is given.

[2] The light-colored part indicates flashing.  No Signal  Weak Signal  Strong Signal.

Operation Guide

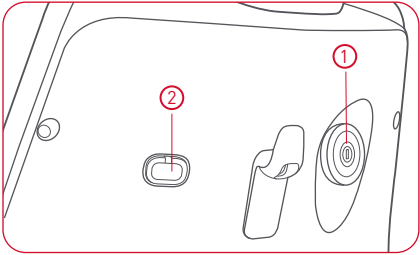

Front Storage Area

- ① Keyhole
- ② USB Port

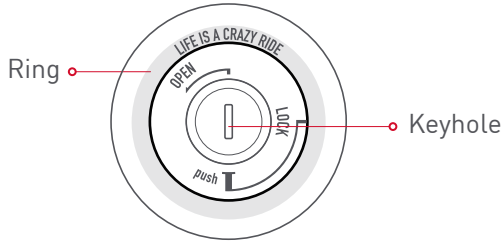

Anti-theft Lock

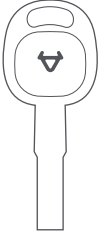

Key

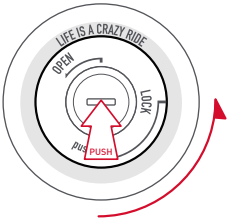

Locking the anti-theft lock

Turn the handlebar all the way to the left, then press down and turn the key counterclockwise to the "LOCK" position.



Saddle Lock

Opening the saddle

Insert the key and turn counterclockwise to the "OPEN" position, you will hear a "snap" when the saddle is opened.

How to use the Remote Control



Unlock Button

Press the button to disarm the alarm.

Start Button

The scooter will be powered on when the Start button is pressed.

Lock Button

Press the Lock button to lock the scooter after riding.

Indicator Light

This will light up when any key of the remote control is pressed, indicating that the remote control is working normally.

⚠ ATTENTION: Make sure that the battery is correctly installed in the scooter before using the remote control, and that the straight distance between the remote control and the scooter is less than 50 m.

Left-hand Combination Switch

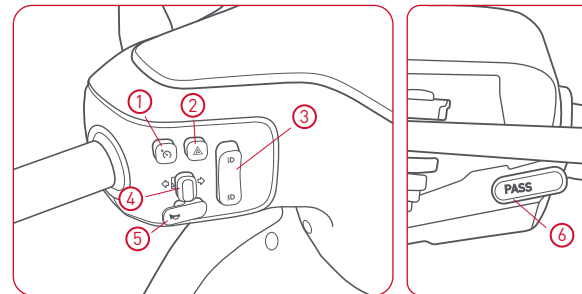

① Cruising Mode

② Hazard Light (flashing lights)

③ High/Low Beam

④ Turn Signal Indicator

⑤ Horn

⑥ Overtaking Light Button



Cruising Mode

Press the button to cruise at current speed.
Press again or brake to turn Cruising Mode off.



Hazard Light (flashing lights)

Both the left and right turn signal indicators will flash when the Hazard Light button is pressed.



High/Low Beam

Push the button up to turn on the high beam;
push the button down to turn on the low beam.



Turn Signal Indicator

Push the button left to turn on the left turn signal indicator;
Push the button right to turn on the right turn signal indicator.



Horn

Press the horn button to sound the horn, and release it to stop.



Overtaking Light Button

To signal overtaking with flashing light, the rider may press and release the Overtaking Light Button repeatedly.

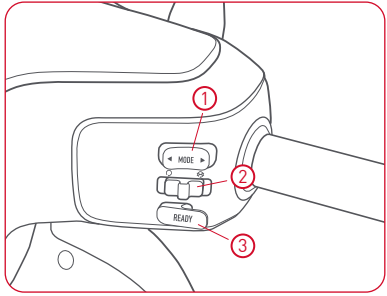

Right-hand Combination Switch

- ① Riding Mode
- ② Safety Switch
- ③ Start Button



Riding Mode

Press the left/right button to switch between riding modes.



Safety Switch

Push the button to the right to cut off the power system.
If you press the button while riding, the scooter will start to coast (power will be cut off);
Push the button to the left to restore power and ride normally.



Start Button

Press the Start button and the scooter will be ready to go.

Start the scooter

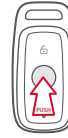

Step 1 Press the Start button on the remote control.



Step 2 Fold away the side stand/central stand and make sure the safety switch is powered on. Press the Start button on the right-hand combination switch and the “READY” indicator on the dashboard will light up.

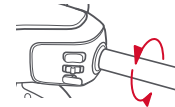

Step 3 Turn the throttle handle gently with your right hand to enjoy your first ride.

Check the scooter parts before riding. If there is any abnormality, repair it or seek profession repair service.

- Check the conditions of the power circuits, lighting circuits, etc;
- Check whether the front and rear brakes are working properly;
- Check the firmness of the steering handlebar and the front and rear wheels;
- Check tire pressure;
- Check the reflector for damage and make sure it is clean.

Locking the scooter

Turn the key to  to turn off the scooter. Turn the steering handlebar to the left, then push the key inward and turn to **LOCK** to lock Steering Handlebar. Press the Lock Button on the Remote Controller within an effective distance to turn on the Alarm. The Turn Signal Indicators will stay on for 2 seconds after the scooter is properly locked.

Locating

Press the Locating Button and the Turn Signal Indicators will flash for 10 seconds. If no further operation during this period, the Alarm will be on for 10 seconds. The Alarm can be cancelled by pressing the Unlock or Lock Button.

Battery Use and Maintenance

Battery Level Indicator

- When the Indicator Button is pressed, the Indicator will light up to show the percentage of the battery. The indicator has 5 sections. Each presents 20% of the battery level.
- If the battery level is less than 20%, the Indicator will flash 3 times.
- When charging, the indicator will flash to show the charging progress. They will stop flashing when the battery is fully charged.
- If all 5 sections flash, it means the battery has fault. Please contact your dealer for consultation.

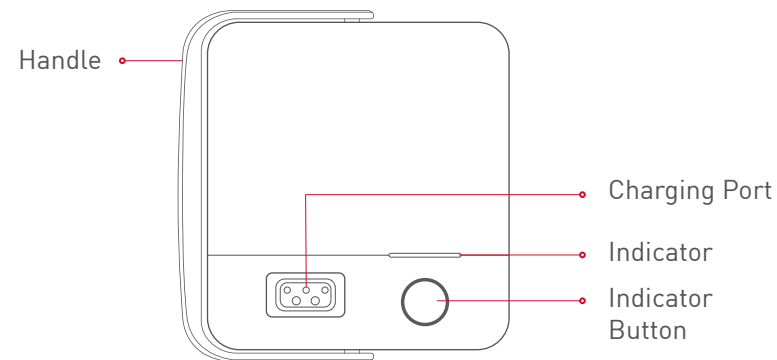

Using Environment

In order to prevent possible leakage, overheat, smoking, fire or explosion, please follow these instructions:

- The battery should be used at the temperature of -10°C to 45°C.
- Do not expose to water, beverages or corrosive liquids.
- Keep away from heat source, open fire, inflammable and explosive gases and liquids.
- Please keep metal parts away from the battery compartment.

In case of undesirable odor, overheat or deformation of the battery, please disuse the battery immediately, keep away from the battery and contact your dealer.

⚠ WARNING: The MQi GT battery is NOT a repairable part by the user. In case of battery fault, please contact your dealer. Users dismantling the battery may lead to leakage, overheat, smoking, fire or explosion. Do not attempt to open or repair the battery, as any attempt to do so will render the warranty invalid.

Charging Environment

The battery should be charged at the temperature of 0°C to 35°C. The charging time should not exceed 24 hours. Overcharging will shorten the battery life.

⚠ ATTENTION: Do not charge the battery below 0°C.

⚠ WARNING: Using non-original battery chargers may lead to leakage, overheat, smoking, fire or explosion.

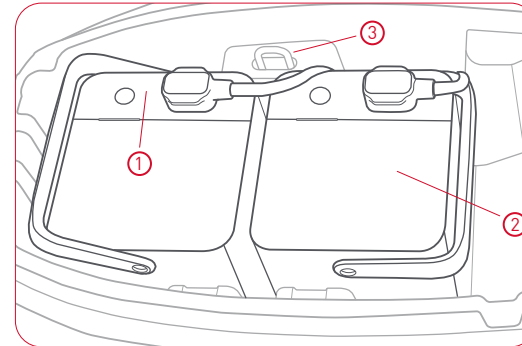

- ① Battery Connector/Charging Port
- ② Battery
- ③ Battery Lock

Charging Methods

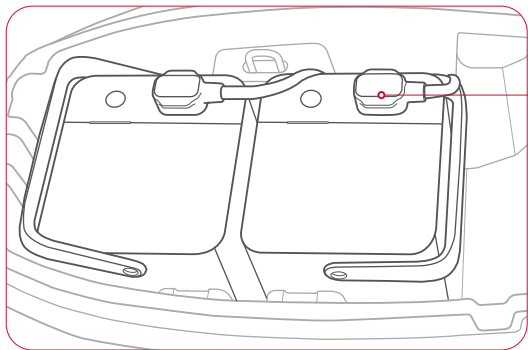

Charging Pot

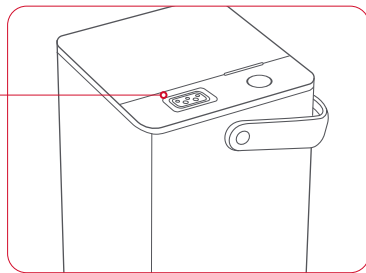

Charging on the Scooter

Open the saddle, open the cover of the connector, and plug the charger into the charging socket.

Charging the Battery

Remove the battery from the scooter. Connect the charger with battery and socket.

⚠ WARNING

- All operation should be strictly conform to the user manual. If not, result will be assumed by user.
- Must use original charger.
- Pay attention to the type of battery and applied voltage. Mixture use is forbidden.
- Charging should be in ventilated environment. DO NOT charge in closed space or under high temperature. DO NOT put charger into trunk or tail box while charging.
- While charging, connect battery with charger before connect with electric supply. After full charged, cut off the electric supply before cut off the battery plug.
- When the green light turns on, please cut off the power in time. Avoid long time connection between charger and AC power supply while not charging.
- While charging, if the signal light is abnormal, has different smell or the charger is over temperature, please stop charging immediately and check or change the charger in time.
- When using and storing the charger, please avoid foreign matter, especially water or other liquid in case of internal short circuit.
- DO NOT bring charger within scooter, if have to, please make sure of damping.
- DO NOT disassemble or change the parts in charger by yourself.

ATTENTION

- If the battery can not be fully charged after 12 hours, please stop charging and contact your dealer.
- To maximize the battery life, please keep the battery percentage within 20% to 80%.
- For storage, please keep the battery under 40°C to prevent irreversible capacity loss of the battery.
- MQi GT battery will lose more capacity in lower temperature conditions. To be more specific, the usable capacity at -10°C is 70%, 85% at 0°C and 100% at 25°C.
- The best battery capacity performance for storage is 50%. Storing battery with less than 10% or more than 90% over a long period of time will cause irreversible capacity loss to the battery.
- **The battery needs to take out from the scooter for storage longer than one week.** In this condition, please keep the battery at the temperature of 0°C to 20°C with capacity of 30%-70%. It's advised to have at least one cycle of charge and discharge every 2 months to minimize battery capacity loss during storage.
- **If the battery failure is due to misuse or lack of proper maintenance as instructed, its warranty will be invalidated.**
- Falling may cause uncontrollable internal damage to the battery and may cause leakage, overheat, smoking, fire or explosion.

DOs and DON'Ts while Riding

Before Riding

Please check the following details before riding.

Check Point	Description
Steering Handlebar	(1) Steadiness (2) Steering flexibility (3) No axial displacement or loosening
Braking	Braking lever has 5 to 9mm idle travel.
Tyres	(1) The air pressure range of the front tyre is 25 to 34 psi (2) Proper tyre tread depth (3) No cracks or openings (4) Minimum load-capacity index: front 21, rear 40. (5) Minimum-speed category: B.
Battery	Adequate for planned distance to travel.
Lights	Check all the lights—High Beam, Low Beam, Brake Light, Turn Signal Indicator, etc.
Horn	Check whether the horn can work.

Reporting Safety Defects

JIANGSU NIU ELECTRIC TECHNOLOGY CO., LTD

No. 387 ChangTing Road, West Taihu Science and Technology Industrial Park
ChangZhou City, Jiangsu Province, China

If you believe that your vehicle has a defect which could cause a crash or could cause injury or death, you should immediately inform the National Highway Traffic Safety Administration (NHTSA) in addition to notifying JIANGSU NIU ELECTRIC TECHNOLOGY CO., LTD.

If NHTSA receives similar complaints, it may open an investigation, and if it finds that a safety defect exists in a group of vehicles, it may order a recall and remedy campaign. However, NHTSA cannot become involved in individual problems between you, your dealer, or JIANGSU NIU ELECTRIC TECHNOLOGY CO., LTD

To contact NHTSA, you may call the Vehicle Safety Hotline toll-free at 1-888-327-4236 (TTY: 1-800-424-9153); go to <http://nhtsa.safercar.gov>; or write to Administrator, NHTSA, 1200 New Jersey Avenue SE, Washington, DC 20590. You can also obtain other information about motor vehicle safety from <http://www.safercar.gov>

Federal Communications Commission (FCC) Compliance Statement for USA

The Smart Central Controller, the Remote Controller and the Alarm comply with part 15 of the FCC rules. Operation is subject to the following two conditions: (1) This device may not cause harmful interference, and (2) this device must accept any interference received, including interference that may cause undesired operation.

Smart Central Controller

FCC ID: 2AQ95-NIUV35LTE

MODEL: V35LTE

Remote Controller

FCC ID: 2AQ95-NIUD23-433

MODEL: D23

Maintenance and Repair

Users are advised to have the scooter checked and maintained on a regular basis, even for scooters that are not used as frequently.

Regular Maintenance

Users are advised to have their scooters checked 2 months after purchased or with 500 km travelled distance. Overall check and maintenance is advised to be conducted every 6 months or 1800 miles thereafter.

Scooter Washing

Please always take out the battery before washing the scooter. Please use neutral detergent and water to wash the scooter. Use soft cloth to wipe the scooter after washing to prevent scratching.

ATTENTION

If the scooter is frequently used in overload, high-speed, bumpy or up/downhill riding conditions, the maintenance cycle should be shortened.

For more guaranteed quality and longer service life, please use original parts, which are under normal warranty.

WARNING

Do not use pressure washer to wash the scooter, especially around the battery compartment. Do not flush the rear inner mudguard, where the charger, controller and other parts are installed behind. If the charging port on the scooter is wetted, please do not charge before the charger dries off. Contacting your dealer is recommended.

Storage Method

Short-term Storage

- Keep the scooter in flat, steady, well-ventilated and dry area.
- Charge the battery to 50% full before storage to maximize battery life.
- Avoid exposure under sunlight and rain to reduce damage or aging.

Long-term Storage

- Remember to have a cycle of charge and a discharge at least every 2 months and charge the battery to 50% full before storage to maximize battery life.
- Charge the battery to 100% full after long-term storage.
- Check all the parts carefully to make sure that there is no problem before riding it. If there's any problem, take the scooter to your dealer for maintenance or repair.

⚠ WARNING: Please take out the battery from the scooter when long-term storage.

Periodic Maintenance Schedule					
Maintenance schedule	After the initial 600 mi	Every 1800 mi	Every 3600 mi	Every year	Every 2 years
COMPONENT:	WHAT TO DO:				
Battery / batteries	I	I	I	I	I
Lights / switches	I	I	I	I	I
Steering bearing	I		I/C/L/A		I/C/L/A
Wheel bearing	I		I		I
Tires	I	I	I	I	I
Rims	I	I	I		
Tight fit of all accessible bolts and nuts	I/T	I/T	I/T	I/T	I/T
Braking system	I	I	I	I	I
Brake fluid	I	I	I	I	R
Side / main stand	I/C/L	I/C/L	I/C/L		I/C/L
Telescopic fork	I		I		I
Rear shock absorber	I		I		I
Throttle grip	I	I	I	I	I
Vehicle road test	I	I	I	I	I
A...Adjust C...Clean I...Inspect, relpace or repair if defective L...Lubricate R...Replace T...Tighten					

Regular Maintenance Checklist	
Regular Safety and Performance Check	Brakes
	Lights
	Horn
	Electric Parts
	Tyres
Structural Check	Lubrication
	Wheel Bearing
	Vibration Damper
	Side Stand
	Steering Bearing
Major Parts	Battery
	Main Wiring Harness
	Control System

Troubleshooting List		
Malfunction Description	Causes	Troubleshooting
No output when switched on	<ol style="list-style-type: none"> 1. Dead battery 2. Battery not connected 3. Alarm failure 	<ol style="list-style-type: none"> 1. Charge the battery. 2. Check if it's properly connected 3. Replace Alarm
Motor failure when turning the twist grip after switched on	<ol style="list-style-type: none"> 1. Battery voltage is low 2. The power off switch is enabled when pulling the brake lever 3. The Parking Mode has not been turned off yet 	<ol style="list-style-type: none"> 1. Charge the battery. 2. Do not pull the brake lever when twisting the twist grip. 3. Check "Start the Scooter" section. Check if the side stand is on.
Battery charge failure	<ol style="list-style-type: none"> 1. Not properly connected 2. Battery temperature is too high or too low 	<ol style="list-style-type: none"> 1. Check whether the plug is loosened. 2. Wait for it to achieve normal temperature.
Dropping speed or range	<ol style="list-style-type: none"> 1. Low battery level 2. Under-inflation of tyres 3. Frequent braking and overload 4. Battery aging or normal capacity loss 5. Low battery capacity resulting from low temperature 	<ol style="list-style-type: none"> 1. Charge the battery and check if the plug is properly plugged in and whether the charger is damaged. 2. Check the tyre inflation every time. 3. Develop good riding habits. 4. Replace the battery. 5. Normal situation.

Troubleshooting List		
Malfunction Description	Causes	Troubleshooting
Sudden stop during a ride	Dead battery	Charge the battery.
	Identify the fault causes in reference to the meter panel fault codes.	

Fault Code List			
Fault Code	Meaning	Causes	Troubleshooting
10	FOC stop working	Motor stucked	Check if the motor is stucked.
11		Undervoltage or overvoltage	Check if the charger is intact.
12		Overcurrent	Contact your dealer if happens often.
13		Controller overheat	Park the bike in shade and wait for it to cool down.
22	BCS overtemperature	BCS temperature is too high	Stop riding and park the bike in the shade to let the battery cool down.
23	BCS belowtemperature	BCS temperature is too low	Get BCS to work in the right temperature environment
30	Battery 1overcharge	Battery in overcharge protection	Turn on headlight to discharge.Check if the charger is broken or wrong type.

Fault Code List			
Fault Code	Meaning	Causes	Troubleshooting
31	Battery 1overcurrent	Battery in overcurrent protection	Stop charging and check if the charger is failed.
50	Battery 2overcharge	Battery in overcharge protection	Turn on headlight to discharge.Check if the charger is broken or wrong type.
51	Battery 2overcurrent	Battery in overcurrent protection	Stop charging and check if the charger is failed.
60	Communication Module failure	SIM card identification failure	Contact your dealer.
65		SN code are not written or Smart central controller serial code are not written	
67		SIM card unpaid or weak signal	
80	stop charging	Charger in overtemperature protection	Remove the charger, and wait it to cool down before charging again. If the problem persists, contact your dealer.
81		Charger in overvoltage protection	Unplug and plug the charger again. If the problem persists, contact your dealer
82		Charger in overcurrent protection	
99	Communication Harness failure	Smart Central Controller or Harness Assembly failure	Contact your dealer.
110	FOC failure	MOSFET failure	Contact your dealer.Contact your dealer.
		MOSFET driver failure	

111	FOC varification failure	Non-original Controller or communication failure	Restart the bike. Contact your dealer if it does not work.
120	Motor failure	Motor Hall Sensor failure	Contact your dealer.Contact your dealer.
		Motor cord disconnected	
121	BCS is not working	BCS Charging MOS or Discharging MOS damaged	Contact your dealer.
122	BCS overcurrent	BCS in overcurrent protection	Unlock and lock the electric switch lock again. If the problem persists, contact your dealer.
123	Motor Houle malfunctioning	Motor Houle signal failure	
130	Battery 1 overdischarge	Battery level is too low and the BMS is about to enter protection mode	Stop riding and charge the battery.
131	Battery 1 overcurrent	Battery is undervoltage or overvoltage	Check if the charger is failed.
132	Battery 1 overtemperature	Battery temperature is too high	Stop riding and park the bike in the shade to let the battery cool down.
133	Battery 1 belowtemperature	Battery temperature is too low	Charge the battery after it reaches the operating temperature range.
134	Battery Pack 1 not discharging	Excessive voltage difference	Contact your dealer.

135	Battery Pack 1 not discharging	Short-circuit between positive and negative electrodes of battery pack or external discharge current exceeding short circuit protection value due to external connection	Contact your dealer.
136	Battery Pack 1 not charging/discharging	Exposure to water due to structural reasons or water detection sensor false alarm	
138		Charging MOS or Discharging MOS damaged	
140	Twist Grip failure	Twist Grip Hall Sensor failure	
141		Twist Grip Open Circuit Failure	
142		Twist Grip Short-circuit failure	
150	Battery 2 overdischarge	Battery level is too low and the BMS is about to enter protection mode	Stop riding and charge the battery.
151	Battery 2 overcurrent	Battery is undervoltage or overvoltage	Check if the charger is failed.
152	Battery 2 overtemperature	Battery temperature is too high	Stop riding and park the bike in the shade to let the battery cool down.
134	Battery 2 belowtemperature	Battery temperature is too low	Charge the battery after it reaches the operating temperature range.
154	Battery Pack 2 not discharging	Excessive voltage difference	Contact your dealer

155	Battery Pack 2 not discharging	Short-circuit between positive and negative electrodes of battery pack or external discharge current exceeding short circuit protection value due to external connection	Contact your dealer.
156	Battery Pack 2 not charging/discharging	Exposure to water due to structural reasons or water detection sensor false alarm	
158	Battery Pack 2 not charging/discharging	Charging MOS or Discharging MOS damaged	
161	Locked bike	The bike is remotely locked by the server.	
165	The two battery packs don't match	Battery 1 and Battery 2 have different capacities , models,etc.	
183	stop charging	Charger in short circuit protection	Remove the charger and check the battery circuit Contact your dealer
190	FOC Communication failure	Can not receive Controller's data	Contact your dealer.
191	Battery communication failure	BMS can't return data or returned data is incorrect	Check the Connector is properly plugged. Contact your dealer if happens often.
192	Battery 2 communication exception	BMS can't return data or returned data is invalid	Check physical connection of communication circuit

193	(Leasing version only)	Lockboard can't return data or returned data is incorrect	Contact your dealer.
194	BCS communication failure	BCS can't return data or returned data is incorrect	

Technical Parameters

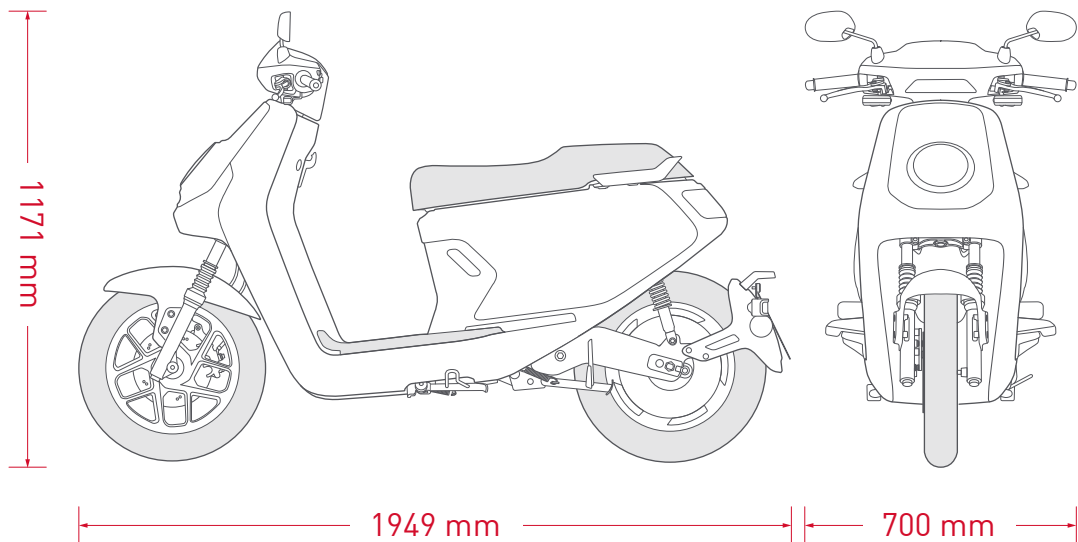

		MQi GT
Features	Motor Rated Power	3000 W
	Battery Capacity	31 Ah x 2
	Speed(unrestricted)	Sport: 70 km/h (43 mph) Dynamic: 55 km/h (34 mph) E-Save: 25 km/h (15 mph)
	Dimension	1949 x 700 x 1171 mm
	Product weight	115 kg
	Maximun Load	269 kg
	Number of seating positions	2
	Range	75-98 km
Battery System	Gradeability	Dynamic:~15°
	Voltage	48 V
	Standard Charging Current	5.2 A
Electrical System	Maximun Discharging Current	18.75 A
	Headlight/Turn/Indicator Taillight/Brake/Light Meter Panel	12 V LED
	Central Control Unit	12 V
Power System	USB Charging	5 V / 1 A
	Motor	Tailored Motor by Bosch GmbH
	Motor Control Mode	FOC Vector Control
	FOC Controller Max. Current	80 A

Frame	Front/Rear Damper	Oil Damping Direct Acting Shock Absorber
	Front Tyre Specification	90/90-14 Rim: 2.15x14
	Rear Tyre Specification	110/80-14 Rim: 2.50x14
	Brake System	Combined Braking System[CBS]
	Minimum Ground Clearance	165 mm
	Seat Height	816 mm

Maintenance Record

Date		Mileage	
Notes:			
Dealer:			

Maintenance Record

Date		Mileage	
Notes:			
Dealer:			

Maintenance Record

Date		Mileage	
Notes:			
Dealer:			

Maintenance Record

Date		Mileage	
Notes:			
Dealer:			

Maintenance Record

Date		Mileage	
Notes:			
Dealer:			

Maintenance Record

Date		Mileage	
Notes:			
Dealer:			

Maintenance Record

Date		Mileage	
Notes:			
Dealer:			

小牛电动 MQi GT 说明书 (DOT) V1.0

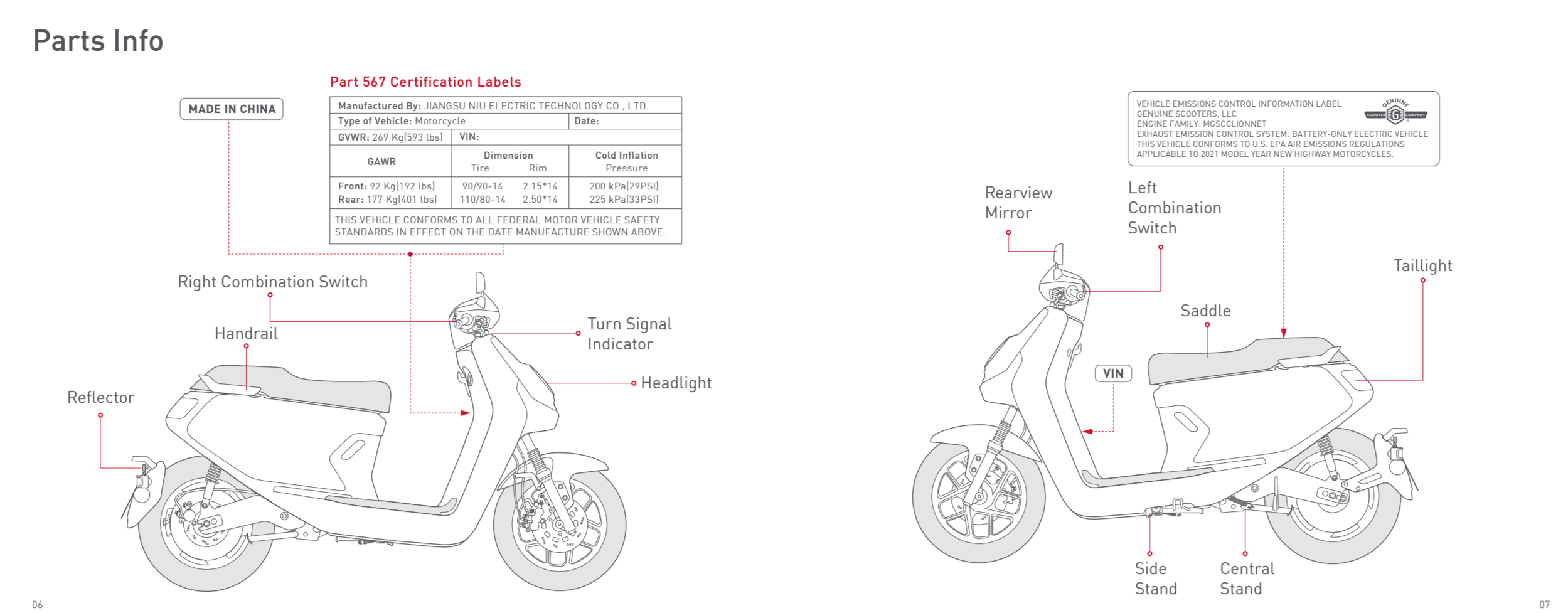

Dashboards and Combination Switches

Light is when in "on" state! charging mode!
Gear Shift Indicator
Riding Mode
Speed
Total Mileage
Headlight
Turn Signal Indicator
Right Combination Switch
Left Combination Switch
Safety Switch
Headlight

WARNING California Proposition 65
Lithium-ion Batteries and/or products that contain Lithium-ion Batteries can expose you to chemicals including Lithium, Ethylbenzene, and Nickel, which are known to the State of California to cause cancer and birth defects or other reproductive harm.
For more information go to www.P65Warnings.ca.gov.

CONTENTS

General Notice 01
Precautions 02
Safety Notice 03
Downloading the APP 04
Installation Guide 05
Parts Info 06
Operation Guide 07
Reporting Safety Defects 08
DOT and DOT'n'ts White Riding 09
Federal Communications Commission (FCC) Compliance Statement for USA 10
Maintenance and Repair 11
Storage Method 12
Technical Parameters 13
Maintenance Record 14

General Notice

Please read this User Manual carefully for proper operation before riding the scooter.
Please follow the traffic laws. Slow down on slippery roads to avoid water or snow spray.
Download the APP for maintenance and repair to help you.
Do not tamper with the scooter's electrical system or any other parts.
Your authorized dealer is the primary resource for information, parts and service. If you have additional questions about the product, please visit www.niu.com.

Operation Guide

Front Storage Area
Locking the anti-theft lock
Opening the saddle
Right-hand Combination Switch
Left-hand Combination Switch
Safety Switch
Headlight

Check the scooter parts before riding

Check the condition of the power circuits, lighting circuits, etc.
Check whether the front and rear brakes are working properly.
Check the tension of the steering handlebar and the front and rear wheels.
When charging, the indicator will flash when the emergency lights are on.
Check the reflector for damage and make sure it is clean.

Using Environment

in order to prevent possible leakage, overheat, or explosion, please follow these instructions:
The battery should be stored at the temperature of -10°C to 40°C.
Do not expose to water, overcharge or over-discharge.
Do not charge in an unventilated space.
Please keep metal parts away from the battery compartment.

Charging Method

Charging on the Scooter
Charging the Battery
Charging the Battery

Battery Level Indicator

When the indicator flashes green, the indicator will light up show the percentage of the battery. The indicator has 5 levels. Each presents 20% of the battery level.
If the battery level is less than 20%, the indicator will flash 3 times.
When charging, the indicator will flash when the emergency lights are on.
When the battery is fully charged.
If full system fault, it means the battery has fault. Please contact your dealer for consultation.

Charging Environment

The battery should be charged at the temperature of 0°C to 30°C. The charging time should not exceed 24 hours. Overcharging will shorten the battery life.
Do not charge the battery before 0°C.
WARNING: Do not use original battery chargers that are damaged, overheat, or explode.

Charging on the Scooter

Plug the connector into the battery and connect your dealer's charger to the charging socket.
Charging the Battery: Disconnect the battery from the charger. Connect the charger with the battery pack.

Maintenance and Repair

Regular Maintenance Checklist
Malfunction Troubleshooting List
Warranty and After-sales Service

Storage Method

Short-term Storage
Long-term Storage

Regular Maintenance Checklist

Item	Frequency	Notes
Check Lights	Before Riding	Check the operation of the lights.
Check Brakes	Before Riding	Check the operation of the front and rear brakes.
Check Tires	Before Riding	Check the air pressure and tread of the tires.
Check Steering	Before Riding	Check the operation of the steering handlebar.
Check Safety	Before Riding	Check the operation of the safety switch and reflector.

WARNING

Do not use original battery chargers that are damaged, overheat, or explode.
Do not charge the battery before 0°C.
Do not use original battery chargers that are damaged, overheat, or explode.

Technical Parameters

Parameter	Value
Max. Power	1500W
Max. Speed	40 km/h
Max. Range	120 km
Max. Load	150 kg
Max. Slope	15%
Max. Rain	IPX4
Max. Humidity	95%
Max. Temperature	50°C
Max. Altitude	3000m

Maintenance Record

Date	Mileage	Notes

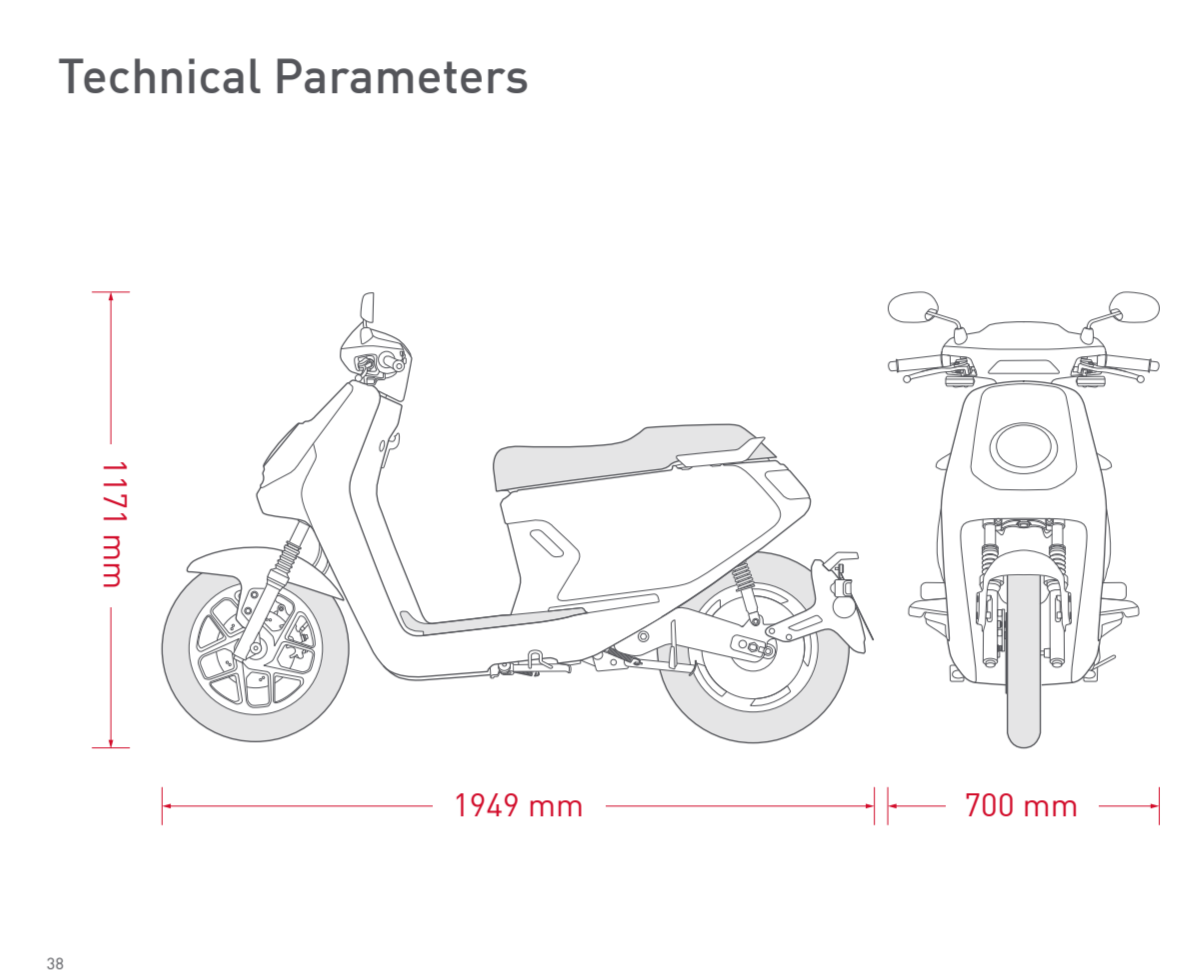

Maintenance Record

Date	Mileage	Notes

Maintenance Record

Date	Mileage	Notes

Maintenance Record

Date	Mileage	Notes

Precautions

Do not exceed speed limit and apply brakes suddenly.
Do not use original battery chargers that are damaged, overheat, or explode.

Safety Notice

Always wear a safety DOT approved helmet as well as suitable eye protection.
Do not drink alcohol before riding.
Do not use the scooter on wet or icy surfaces.
Do not use the scooter on slippery roads to avoid water or snow spray.

How to use the Remote Control

Unlock Button
Start Button
Lock Button
Light Button

Left-hand Combination Switch

Crash Mode
High Light Beam
Right Light Beam
Turn Signal Indicator
Overriding Light Buttons

DOTs and DOT'n'ts White Riding

Before Riding
Please check the following details before riding:
Check the operation of the lights.
Check the operation of the front and rear brakes.
Check the air pressure and tread of the tires.

Malfunction Troubleshooting List

Malfunction	Causes	Troubleshooting
Light is not working	Bulb is not installed correctly.	Check the bulb installation.
Light is dim	Bulb is not fully inserted.	Check the bulb insertion.
Light is flickering	Bulb is not fully inserted.	Check the bulb insertion.

Fault Codes List

Code	Meaning	Causes	Troubleshooting
01	Motor stall	Motor stall	Check if the motor is locked.
02	Battery low	Battery low	Check the battery level.
03	Battery overcharge	Battery overcharge	Stop charging and check the charger cable.

Downloading the APP

Functions such as checking battery level, locating, and management can be implemented at the electric scooter through the app.
Scan the QR code below to download the APP.
Run Setup after downloading and register.
Please scan the QR code on the inside of cover cap for app registration.

Installation Guide

Right-hand Combination Switch
Safety Switch
Headlight

Start the scooter

Press the Start button on the remote control.
Hold the side stand upright and make sure the safety switch is pressed on.
Turn the throttle handle gently with your right hand to enjoy your ride.

Reporting Safety Defects

URGENT! Niu Electric Technology Co., Ltd.
URGENT! Niu Electric Technology Co., Ltd.
URGENT! Niu Electric Technology Co., Ltd.

Federal Communications Commission (FCC) Compliance Statement for USA

The Smart Central Controller, the Remote Controller and the Alarm comply with part 15 of the FCC rules. Operation is subject to the following two conditions: (1) This device may not cause harmful interference, and (2) this device must accept any interference received, including interference that may cause undesired operation.

Malfunction Troubleshooting List

Malfunction	Causes	Troubleshooting
Light is not working	Bulb is not installed correctly.	Check the bulb installation.
Light is dim	Bulb is not fully inserted.	Check the bulb insertion.
Light is flickering	Bulb is not fully inserted.	Check the bulb insertion.

Fault Codes List

Code	Meaning	Causes	Troubleshooting
01	Motor stall	Motor stall	Check if the motor is locked.
02	Battery low	Battery low	Check the battery level.
03	Battery overcharge	Battery overcharge	Stop charging and check the charger cable.

Maintenance Record

Date	Mileage	Notes

Maintenance Record

Date	Mileage	Notes

Maintenance Record

Date	Mileage	Notes

Maintenance Record

Date	Mileage	Notes

Precautions

Do not exceed speed limit and apply brakes suddenly.
Do not use original battery chargers that are damaged, overheat, or explode.

How to use the Remote Control

Unlock Button
Start Button
Lock Button
Light Button

Left-hand Combination Switch

Crash Mode
High Light Beam
Right Light Beam
Turn Signal Indicator
Overriding Light Buttons

DOTs and DOT'n'ts White Riding

Before Riding
Please check the following details before riding:
Check the operation of the lights.
Check the operation of the front and rear brakes.
Check the air pressure and tread of the tires.

Malfunction Troubleshooting List

Malfunction	Causes	Troubleshooting
Light is not working	Bulb is not installed correctly.	Check the bulb installation.
Light is dim	Bulb is not fully inserted.	Check the bulb insertion.
Light is flickering	Bulb is not fully inserted.	Check the bulb insertion.

Fault Codes List

Code	Meaning	Causes	Troubleshooting
01	Motor stall	Motor stall	Check if the motor is locked.
02	Battery low	Battery low	Check the battery level.
03	Battery overcharge	Battery overcharge	Stop charging and check the charger cable.

Maintenance Record

Date	Mileage	Notes

Maintenance Record

Date	Mileage	Notes

Maintenance Record

Date	Mileage	Notes

Technical Parameters

Max. Power: 1500W
Max. Speed: 40 km/h
Max. Range: 120 km
Max. Load: 150 kg
Max. Slope: 15%
Max. Rain: IPX4
Max. Humidity: 95%
Max. Temperature: 50°C
Max. Altitude: 3000m

Maintenance Record

Date	Mileage	Notes

Maintenance Record

Date	Mileage	Notes

Maintenance Record

Date	Mileage	Notes

Maintenance Record

Date	Mileage	Notes

Maintenance Record

Date	Mileage	Notes

Maintenance Record

Date	Mileage	Notes

Maintenance Record

Date	Mileage	Notes

Maintenance Record

Date	Mileage	Notes

Sample version

Technical specifications

Maintenance record

Maintenance record

Maintenance record

Maintenance record

Maintenance record

Maintenance record

Maintenance record

Technical specifications